

# ORHI

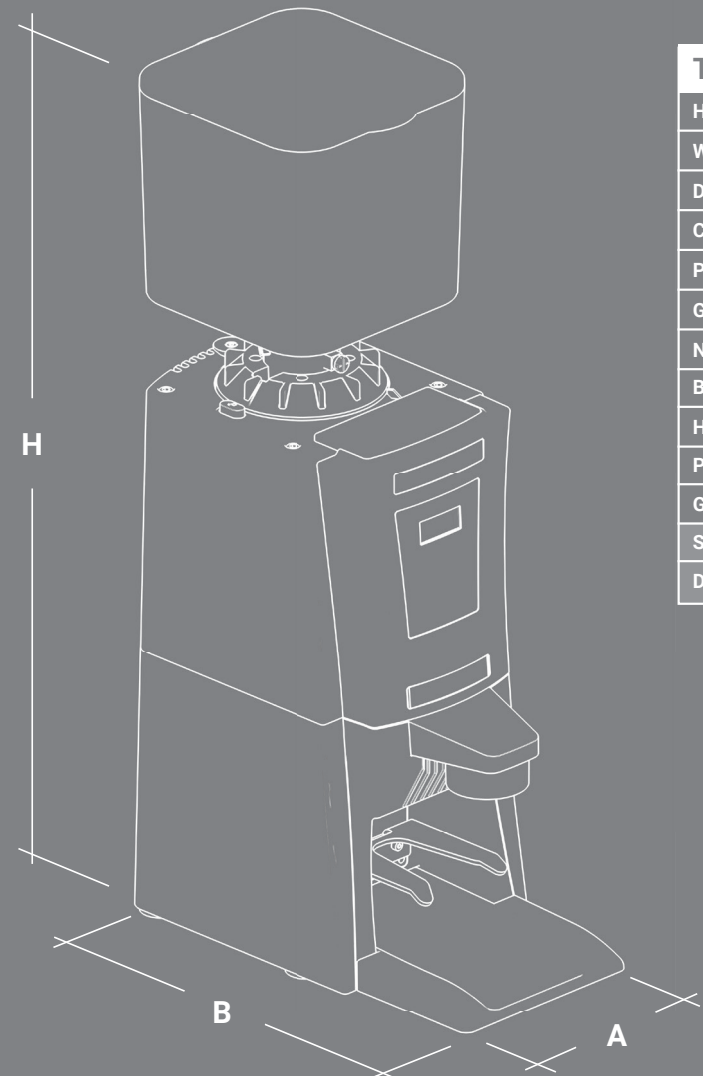

Technical Specifications	EN
Height (H)	630 mm - 24,80 inches
Width (A)	180 mm - 7,08 inches
Depth (B)	352 mm - 13,85 inches
Connected load	230 V - 50 Hz
Power	525 W
Grinding burrs speed	1350 rpm
Net weight	15 kg
Burrs	Ø 64 mm. Plain
Hopper capacity	1,5 kg / 3,3 lb
Production per hour	7 kg/h
Grinder capacity	4 g/s
Single dose	5 - 18 g
Double dose	5 - 28 g

## IZAGA



**High consistency in each cup of coffee.**

The new **IZAGA** coffee grinder combines innovation, advanced technology and a modern aesthetic to offer a professional and precise automatic grinder that responds to the requirements of a high coffee consumption customers.

## QUIMBOA



**Efficiency from the first to the last coffee cup.**

The compact and robust design of the **QUIMBOA** automatic coffee grinder offers maximum performance and efficiency to meet the needs of the Horeca's professional.

## ASPE



**As versatile as your demands.**

The **ASPE** professional coffee grinder is specifically designed for the baristas. It adapts to all your grinding needs, from special coffees to rush hours working.

**mar K ibar**

**The ideal automatic coffee grinders for your Horeca business**

Convenience, robustness, easy to maintain, easy to clean and dosage accuracy. Those are some of the features of the **MARKIBAR®** coffee grinders.

**More than 30 years of R&D at the service of coffee professionals**



**MARKIBAR® is a leading company in Research, Design, Development and Manufacture of automatic coffee grinders for the HORECA professionals.**

For 30 years, we have worked to offer our customers innovative solutions to guarantee the coffee's quality in each cup.

We bring all our experience and passion for innovation to create automatic coffee grinders, who make the work of the Horeca professional easier.

We manufacture our products with local suppliers, guaranteeing quality, reliability and service from our facilities located in North of Spain.



Pol. Ind. Noáin-Esqiroz C/ G, Nave 39  
31191 Esqiroz, Navarra (España)  
+34 948 317 906 - info@markibar.com  
[www.markibar.com](http://www.markibar.com)

# ORHI

**Design and effectiveness at the service of coffee professionals**

The new **ORHI** coffee grinder brings the most advanced technology of **MARKIBAR®** in a sleek design to offer hospitality professionals a quick, effective automatic grinder in line with the new demands and trends in the industry.

**mar K ibar**



The ORHI professional grinder guarantees **precise grinding, high performance** at peak times and **no coffee going to waste**, all with a modern, up-to-date design.

## Design and effectiveness at the service of coffee professionals

# ORHI

mar **K** ibar

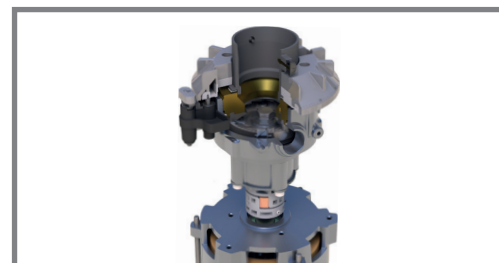

### Isolated grinding chamber

The ORHI automatic coffee grinder has the most advanced technology to guarantee its high performance.

The design of the independent grinding chamber, thermally isolated from drive motor allows cold grinding, even for large coffee consumption.

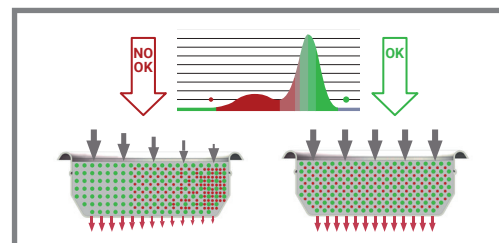

### Homogeneous coffee extraction



The balanced distribution of microfinos on portafiltre allows a homogeneous extraction of coffee to get the maximum performance.

### Maximum convenience with two work modes

#### ON DEMAND Maximum freshness of freshly ground coffee.

On mode On Demand ORHI coffee is ground when the 1 or 2 coffee porta-filter requests it.

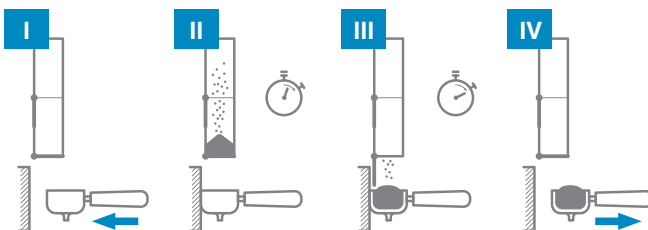

**Uniform coffee delivery**

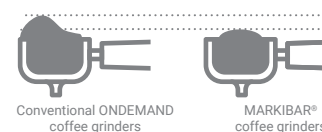

#### PRE-GROUND / INSTANT DOSE Maximum performance for rush hours.

On mode Pre-Ground ORHI, 1 or 2 coffee doses are available in the grinder doser. When the porta filter requests it, the dose is delivered instantly.

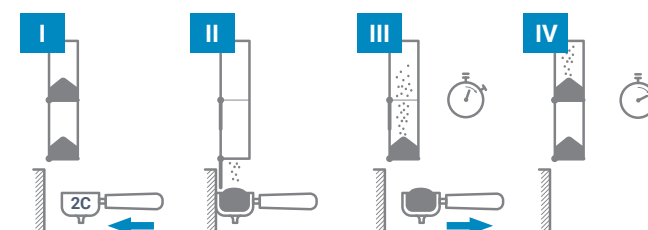

#### Quicker. More compact. Less waste.

Thanks to the built-in dispenser on the ORHI automatic grinder, the filter receives the ground coffee in a compact dose which optimizes preparation time and avoids waste.

### Colour

Choose the colour of your Orhi professional coffee grinder:

- **Black & White**, the standard finish, for a modern, elegant look.
- Special monochrome **black** or **white** finishes.



### Customization

ORHI allows you to customize your grinder to promote your brand.

The hopper design provides a highly visible advertising space to promote the desired brand.

There is also the possibility of adding advertising on the backlit panel at the front

### Barista option

ORHI is available with and without tamper, according to your preferences.

The standard grinder is supplied with a 57 mm and 53 mm diameter tamper. There is also the option of a coffee grinder without a fixed tamper, to be used by external tamper..

### Online Management (optional)

Check the performance data of your ORHI remotely.

IZAGA completes its features with the option of an online management system to know the coffee grinder information anywhere, anytime via your computer, tablet or smartphone.

